

# Oscillating Mountings

Type AB-HD (standard blue)

Type ABI-HD (stainless steel)

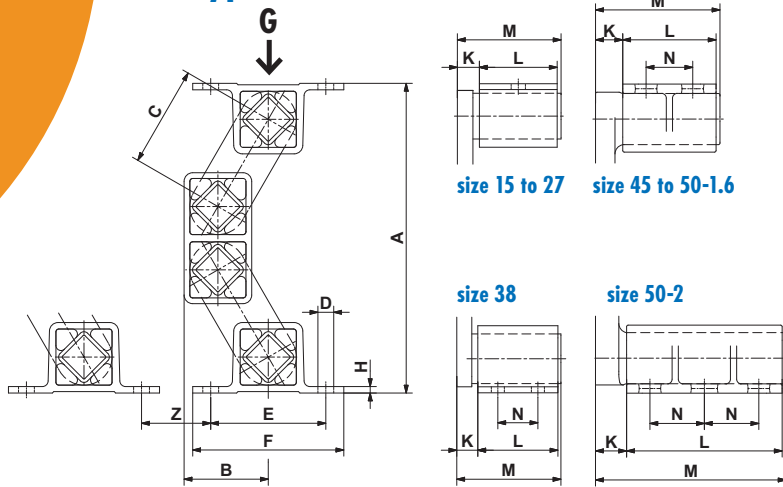

Oscillating Mountings

Art. No.	Type	Load capacity Gmin. – Gmax. [N]	A un- loaded	A* max. load	B un- loaded	B* max. load	C	D	E	F	H	K	L	M	N	Weight [kg]
07 171 121	<b>ABI-HD 15</b>	150 – 400	132	107	36	50	45	7x10	50	65	3	10	40	52	–	0.8
07 171 128	<b>ABI-HD 18</b>	300 – 700	171	141	47	64	60	9x15	60	80	3.5	14	50	67	–	1.5
07 051 070	<b>AB-HD 27</b>	500 – 1'250	215	182	59	78	70	ø11 11x20	80	105	4.5	17	60	80	–	2.0
07 171 123	<b>ABI-HD 27</b>															3.3
07 051 071	<b>AB-HD 38</b>	1'200 – 2'500	293	246	79	106	95	ø13 13x20	100	125	6	21	80	104	40	4.9
07 171 124	<b>ABI-HD 38</b>															7.3
07 051 072	<b>AB-HD 45</b>	2'000 – 4'200	346	290	98	130	110	13x26	115	145	8	28	100	132	58	11.3
07 171 125	<b>ABI-HD 45</b>				94	126										13.6
07 051 062	<b>AB-HD 50</b>	3'500 – 8'400	376	313	105	141	120	17x27	130	170	12	40	120	165	60	20.4
07 171 126	<b>ABI-HD 50</b>															22.3
07 051 063	<b>AB-HD 50-1.6</b>	4'800 – 11'300	376	313	105	141	120	17x27	130	170	12	40	160	205	70	27.1
07 051 060	<b>AB-HD 50-2</b>															32.4
07 171 127	<b>ABI-HD 50-2</b>	6'000 – 14'000	376	313	105	141	120	17x27	130	170	12	45	200	250	70	35.8

Art. No.	Type	Natural frequency Gmin. – Gmax. [Hz]	Z	Dynamic spring value		Capacity limits by different rpm						Light metal profile	Steel welded construction	Nodular cast iron	ROSTA blue painted	Stainless steel casting
				cd vertical [N/mm]	cd horizontal [N/mm]	720 min <sup>-1</sup>		960 min <sup>-1</sup>		1440 min <sup>-1</sup>						
07 171 121	<b>ABI-HD 15</b>	5.8 – 3.6	35	18	10	8	2.3	7	3.6	5	5.8					x
07 171 128	<b>ABI-HD 18</b>	4.9 – 3.2	50	32	20	10	2.9	9	4.6	7	8.1					x
07 051 070	<b>AB-HD 27</b>	4.8 – 3.1	60	70	33	12	3.5	10	5.2	8	9.3	x	x		x	
07 171 123	<b>ABI-HD 27</b>															
07 051 071	<b>AB-HD 38</b>	3.6 – 2.7	90	100	48	15	4.3	13	6.7	8	9.3	x	x		x	
07 171 124	<b>ABI-HD 38</b>															
07 051 072	<b>AB-HD 45</b>	3.3 – 2.5	100	150	72	17	4.9	14	7.2	8	9.3	x	x	x	x	
07 171 125	<b>ABI-HD 45</b>															
07 051 062	<b>AB-HD 50</b>	3.2 – 2.4	120	270	130	18	5.2	15	7.7	8	9.3			x	x	
07 171 126	<b>ABI-HD 50</b>															
07 051 063	<b>AB-HD 50-1.6</b>	3.2 – 2.4	120	360	172	18	5.2	15	7.7	8	9.3	x	x	x	x	
07 051 060	<b>AB-HD 50-2</b>															
07 171 127	<b>ABI-HD 50-2</b>			450	215	18	5.2	15	7.7	8	9.3			x	x	

Values in nominal load range at 960 min<sup>-1</sup> and sw of 8 mm

Acceleration > 9.3 g is not recommended

Material structure

# Element heights and cold flow behaviour AB-HD and ABI-HD

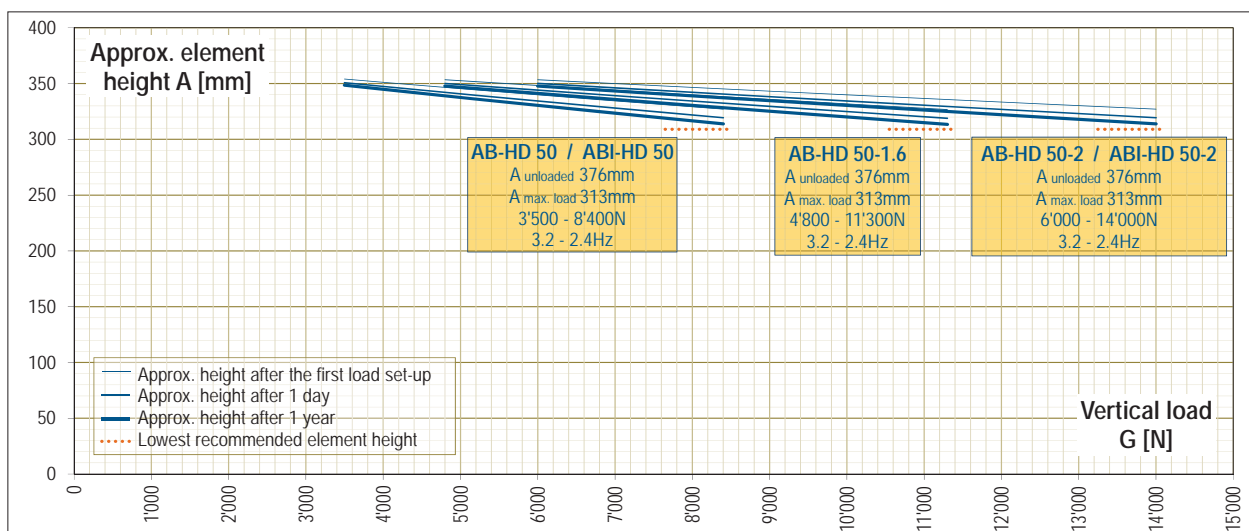
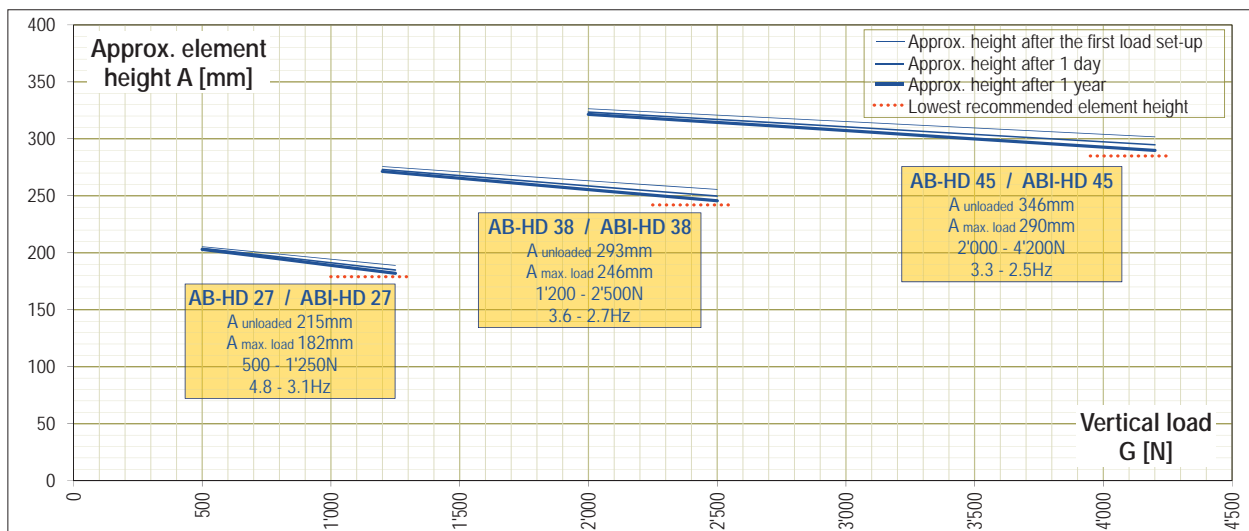
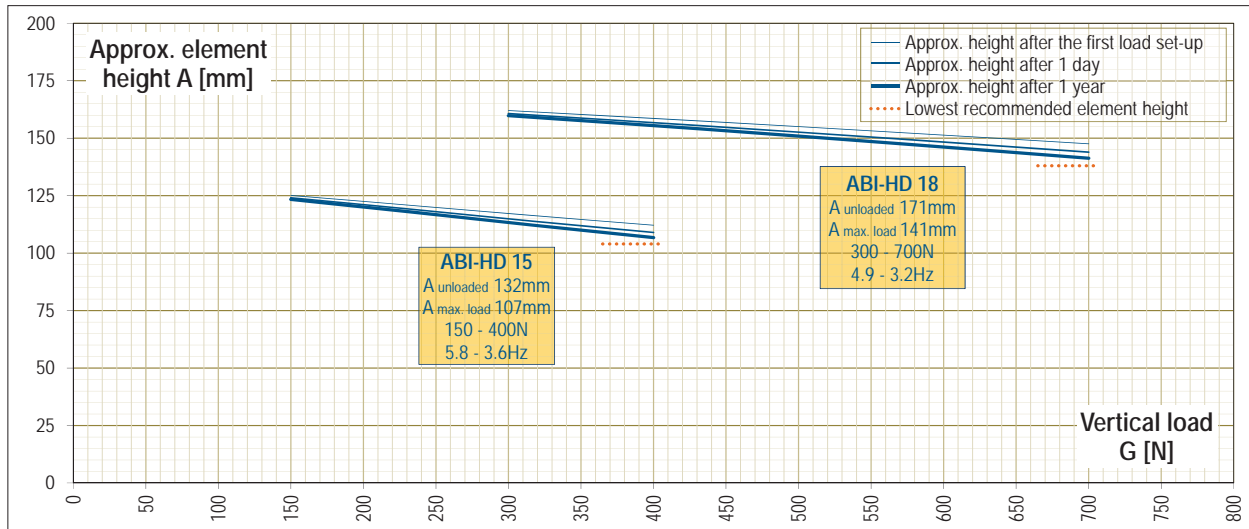

Oscillating Mountings