



## MINIFIX®

### DESCRIPTION

The MINIFIX® mount comprises an elastomer pad with an anti-slip ridged surface and a threaded stud allowing accurate height adjustment of equipment. Made in two hardnesses (50 and 80 Sh) the MINIFIX® mount is perfectly suited to a variety of applications and is delivered complete with fixing nuts and washers. MINIFIX® mounting nuts and screws are made of steel or stainless steel.

### CHARACTERISTICS

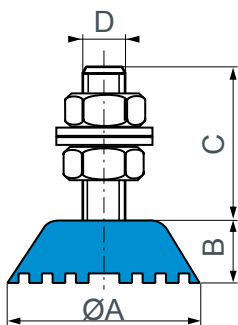

Reference Stainl. steel	Reference Steel	Hardness	Colour	Ø A (mm)	B (mm)	C (mm)	D	Load range (daN)
-	530801	50 SBR 80 Nitrile	grey black	32	15	38	M8 stud	5-30 15-70
-	530802*	50 SBR 80 Nitrile	grey black	46	15	-	M10 nut	10-80 25-200
530806	530805	50 SBR 80 Nitrile	grey black	46	15	38	M10 stud	10-40 25-100
-	530807	50 SBR 80 Nitrile	grey black	70	25,5	55,5	M12 stud	50-120 100-350

See current price list availability of items.

\* Threaded centre hole.

### APPLICATIONS

Simple and economic, MINIFIX® mountings are particularly suitable for the installation of equipment such as :

- Electrical or electronic enclosures.
- Packaging equipment.
- Test and measuring equipment.
- Equipment for the food industry.
- Laboratory equipment.
- Household appliances.



**HUTCHINSON®**  
PAULSTRA

PAULSTRA - 61 rue Marius Auphan - 92309 Levallois-Perret Cedex - France - T. +33 1 40 89 53 31 - F. +33 1 47 25 28 96  
www.paulstra-industry.com